

# TOGE TSM PB

Aerated concrete screw for easy installation - even without pre-drilling

## Fast and easy installation

Installation possible with and also without pre-drilling.



## High service loads

High recommended loads for various aerated concrete strengths.

## Approval

### Base Material

Aerated concrete

## Technical Data <sup>1)</sup>

### Without fire exposure, Steel

Screw size TSM PB			8	10
Drill bit diameter	$d_0$	[mm]	0/4	0/4
Depth of drill hole	$\geq h_1$	[mm]	0/40	0/50
Embedment depth of anchor	$\geq h_{nom}$	[mm]	80	100
Recommended load for PP2 -0,50 <sup>2)</sup>	$F_{empf.}$	[kN]	0,34	0,47
Recommended load for PP4 -0,65 <sup>2)</sup>	$F_{empf.}$	[kN]	0,68	0,92
Recommended load for PP6 -0,80 <sup>2)</sup>	$F_{empf.}$	[kN]	0,99	x
Recommended load for PP3,3 -0,60 <sup>2)</sup>	$F_{empf.}$	[kN]	x	0,94
Recommended load for PP4,4 -0,70 <sup>2)</sup>	$F_{empf.}$	[kN]	x	0,90
Diameter of clearing hole in the fixture	$d$	[mm]	9,0	10,0
Installation torque	$T_{inst.}$	[Nm]	8	12

<sup>1)</sup> All specified values apply for installation with pre-drilled hole!

<sup>2)</sup> The partial safety factor  $\gamma=5$  was considered for determining the load.

## Installation Instructions

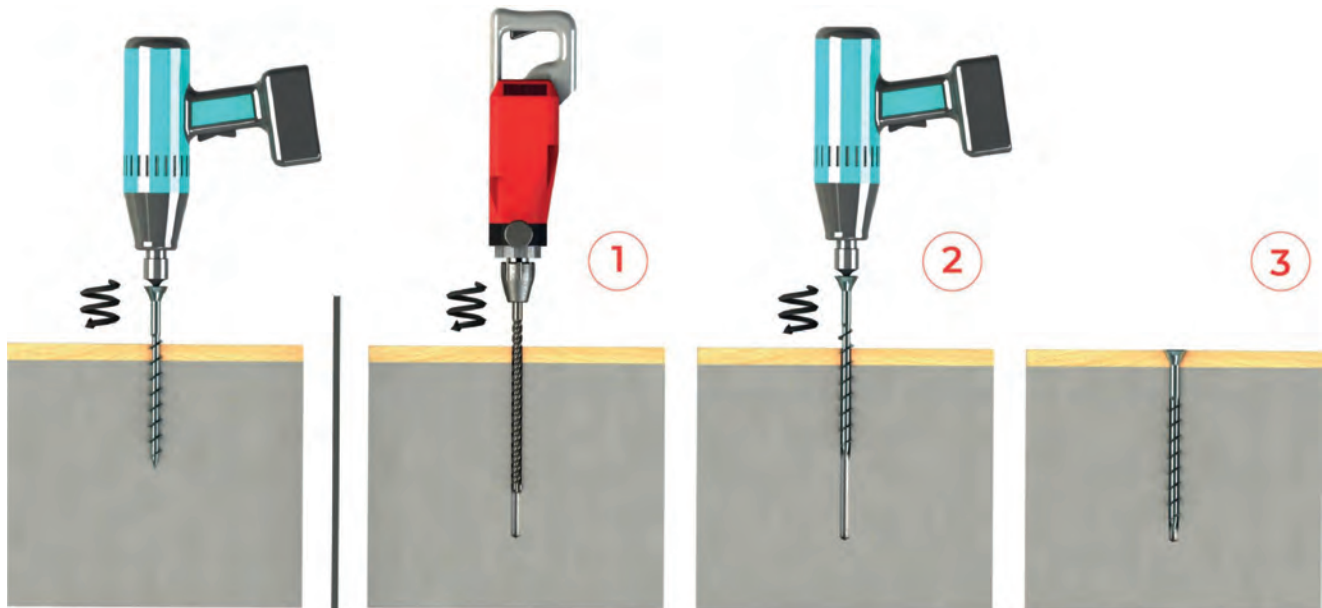

Direct installation

Installation with pre-drilling: Achieves greater load capacity

### Direct Installation

Screw in without predrilling.

### Installation with pre-drilling

- 1) Create drill hole
- 2) Screw in the screw.
- 3) The screw head must rest completely on the attachment part.